

# How to do automatic cleanup of suspicious certificates through Comodo Client Security

## Introduction:

This option in Comodo Client Security will allow you to automatically cleanup the suspicious/untrusted certificates in the end point device.

**Note:** This feature can be enabled only at the end point of the device in the Comodo Client Security application. It is not applicable through the Endpoint Manager.

**Step 1:** Open the **Comodo Client Security** → click **'Settings'** on the CCS home tasks screen. **'Advanced Settings'** interface will be displayed.



**Step 2:** Click **'Advanced Protection'** → **'Miscellaneous'** on the left. You will find the interface **'Do not automatically cleanup suspicious certificates'**



i) If you enable the **'Do not automatically cleanup suspicious certificates'** option by selecting the checkbox, the CCS will not perform automatic cleanup on suspicious/untrusted certificates.



ii) If you disable the **'Do not automatically cleanup suspicious certificates'** option by unselecting the checkbox, the CCS will perform automatic cleanup on suspicious/untrusted certificates.

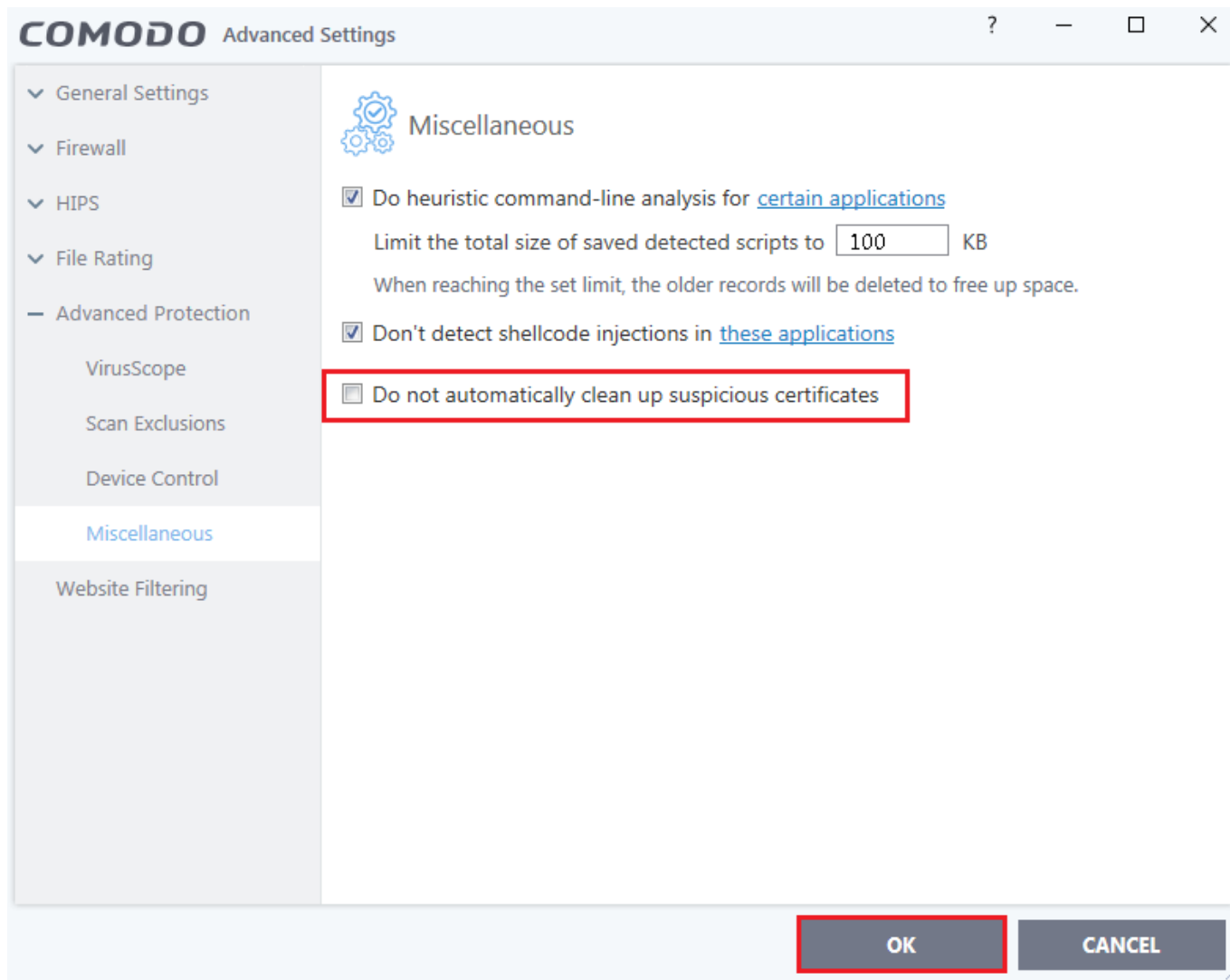

Click 'OK' to apply the settings.