

# How to view help videos on patch management

Open Endpoint Manager > click 'Applications' > 'Patch Management'.

- Endpoint Manager features help videos that guide you on various patch management tasks
- You can view them from the patch management interface

## Open the videos

- Login to Comodo One / Dragon Portal
- Click 'Applications' > 'Endpoint Manager'
- Click 'Applications' on the left then 'Patch Management'

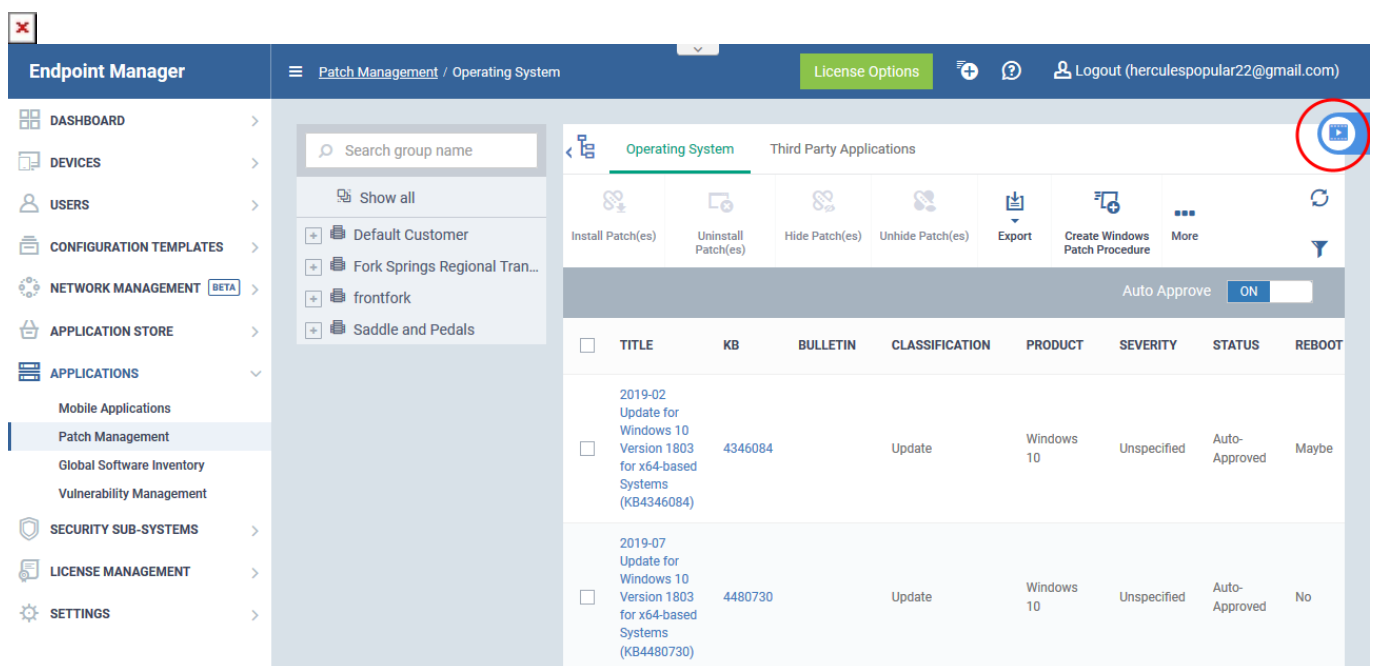

- Click the slider at top-right
- It contains links to help videos on various patch management tasks:

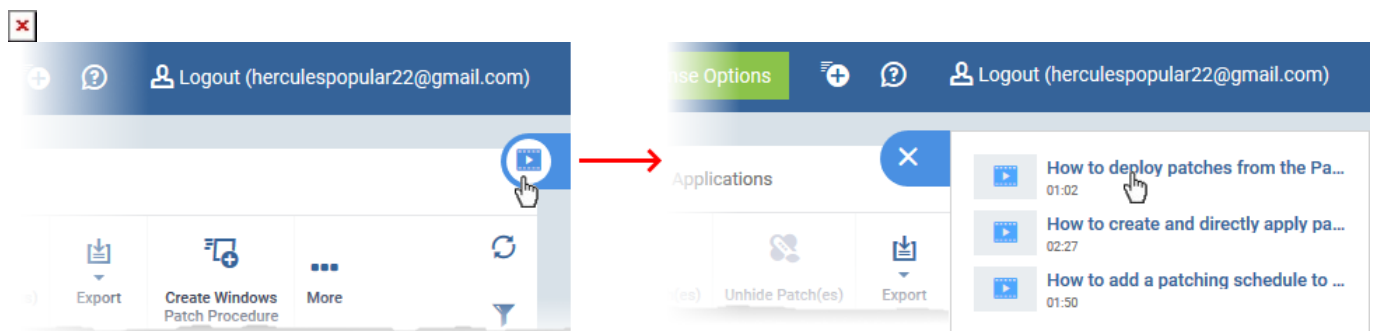

- Select the task you need help with.

The video plays in a pop-up window:





How to deploy patches from the Pa...  
01:02



How to create and directly apply pa...  
02:27



How to add a patching schedule to ...  
01:50